

## Food Guardian ST Range Brochure

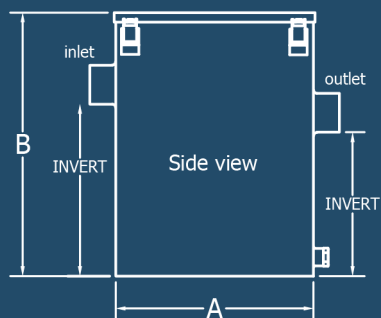

Side View



Front View

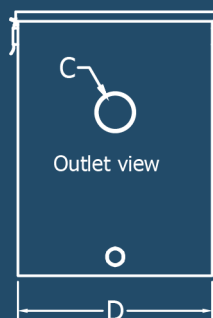

Basket Clearance

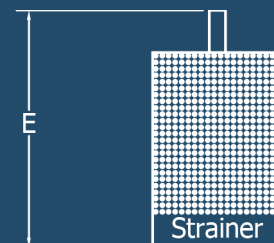

Model	Depth (A)	Height (B)	Diameter (C)	Width (D)	Basket Clearance (E)	Invert Levels
ST1	88	164	N/A	88	N/A	N/A
ST8	305	405	60	300	350	320 / 220
ST12	305	500	89	300	460	340 / 340
ST24	405	562	115	300	525	420 / 25

All dimensions in mm. Inlet / outlet height from the bottom of the pipe.

**RGR Facilities Ltd**

Unit 1C Westpoint  
36-37 Warple Way  
London, W3 0RG

**T** : 020 7221 6094

**M** : 077 1564 3579

**W** : rgrfacilities.co.uk

## Food Guardian How it Works

### Regular Strainer Basket

Wastewater from the kitchen is directed through the inlet of the Food Guardian, where a strainer basket collects any solid debris, while water discharges to drain.

### Fine Mesh Filter Basket

The fine mesh filter basket is used to prevent fine food particles that might otherwise pass through the metal strainer basket entering the drain line.

### Coffee Filtration Option

The coffee filter sock option comes with a further connection to attach the sock to the inlet, preventing used coffee grounds causing blockages & bad odours.



Robust stainless steel construction

Optional mesh basket for fine food

Optional coffee filter sock version

Collected waste can be recycled

Decreases risk of blockages

Low outlet version available

Easy to install and maintain

Extended warranty options

Designed for food prep sinks

No drain dosing units needed

Adjustable mesh filtration bag

Filters solids & food at source

### Specification

Floor standing sediment trap. 1.2mm / 1.5mm, 304 Stainless Steel with bright finish.

Note: Low outlet level of 25mm is standard for ST23 models and optional on request for ST8 and ST12 models.

### RGR Facilities Ltd

Unit 1C Westpoint  
36-37 Warple Way  
London, W3 0RG

**T** : 020 7221 6094

**M** : 077 1564 3579

**W** : rgrfacilities.co.uk